

# PVM



Nominal size				Max working pressure	Rated flow	Max flow rate	Min burst pressure			Fluid spillage
DNP	BG	ISO	mm				Male	Female	Coupled	
06	1	6.3	3,7	70	5	10	270	200	220	0,5
10	2	10	5	100	10	20	280	340	330	1,7

## Caratteristiche tecniche

- Intercambiabilità: con i principali produttori
- Occlusione: valvola
- Aggancio: a vite
- Materiale: acciaio
- Finitura: Zn-Fe (Cr III)
- Filettature: BSP – NPT
- Guarnizioni standard: NBR
- Temperatura d'esercizio: -25 °C +100 °C
- Guarnizioni opzionali: FKM, EPDM o altro
- Pressioni di esercizio: 700 bar
- Connessione in pressione: non consigliata

## Technical data

- Interchange: with the main producers
- Occlusion: poppet
- Locking: screw
- Material: steel
- Finishing: Zn-Fe (Cr III)
- Threads: BSP – NPT
- Standard seals: NBR
- Working temperature: -25 °C +100 °C
- Optional seals: FKM, EPDM or more
- Working pressure: 700 bar
- Connection under pressure: not suggested

## Technische Merkmale

- Austauschbarkeit: mit den wichtigsten Lieferanten
- Verschluss: ventil
- Kupplung: Schraubweise
- Werkstoff: Stahl
- Ausführung: Zn-Fe (Cr III)
- Gewinde: BSP – NPT
- Standard-Dichtungen: NBR
- Betriebstemperatur: -25 °C +100 °C
- Dichtungen nach Wahl: FKM, EPDM, usw.
- Betriebsdruck: 700 bar
- Kuppeln unter Druck: nicht empfohlen

## Caracteristiques techniques

- Intercambiabilité: avec les principaux producteurs
- Obturation: clapet
- Accrochage: a vissé
- Matériel: acier
- Traitement: Zn-Fe (Cr III)
- Taraudage: BSP – NPT
- Joints standard: NBR
- Température de service: -25 °C +100 °C
- Joints facultatifs: FKM, EPDM, ect.
- Pression de service: 700 bar
- Connexion sous pression: non conseillée

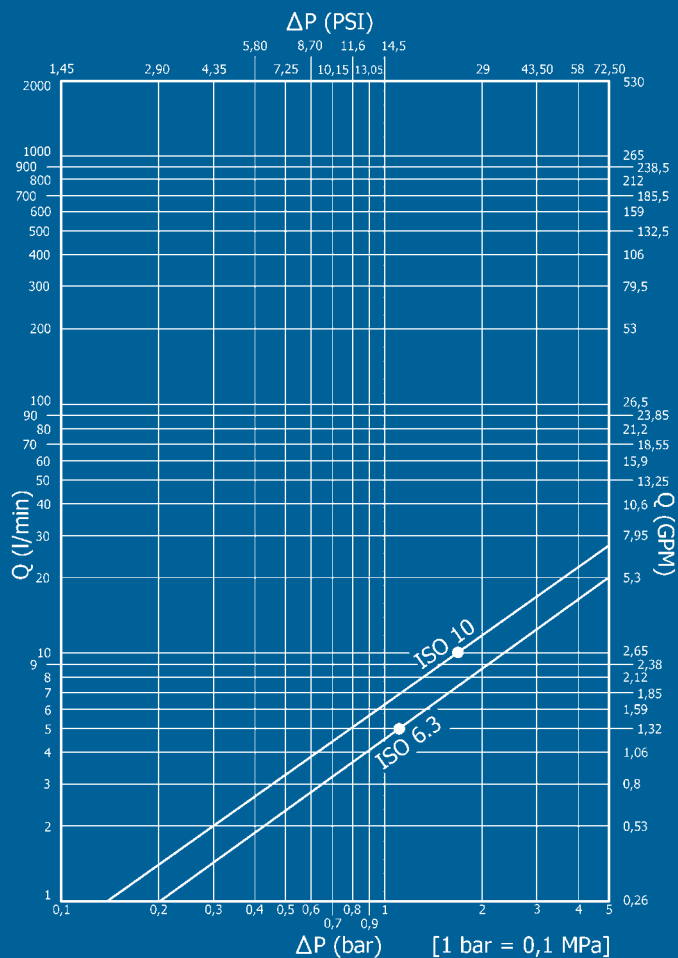

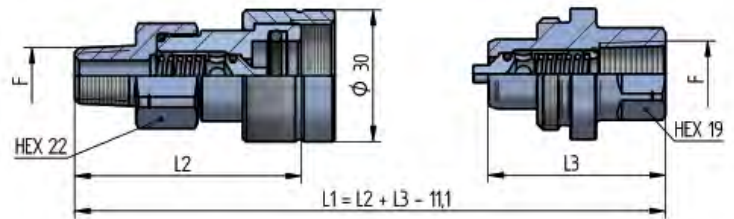
**PVM DN06 - BG 1 - ISO 6.3**

THREADS	L2	L3	L4	F	STANDARD	FEMMINA - FEMALE - MUFFE - FEMELLE			MASCHIO - MALE - STECKER - MALE		
						COD. F	Weight (g)	Packaging (pcs.)	COD. M	Weight (g)	Packaging (pcs.)
<b>IG 1</b>	51,3	40,4		BSP 1/4"	DIN 3852-2-X	PVM3.0606.112	149	100	PVM1.0606.003	90	120
	51,3	40,5		NPT 1/4"	ANSI B1.20.3	PVM3.0606.012	150	100	PVM1.0606.013	91	120
<b>AG 7</b>	51,8		14	NPT 1/4"	ANSI B1.20.3	PVM3.0606.022	131	100			

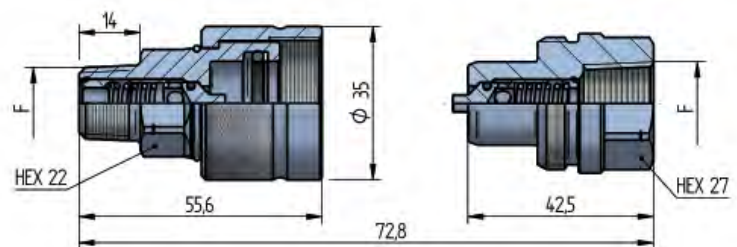
**PVM DN10 - BG 2 - ISO 10**

THREADS	F	STANDARD	FEMMINA - FEMALE - MUFFE - FEMELLE			MASCHIO - MALE - STECKER - MALE		
			COD. F	Weight (g)	Packaging (pcs.)	COD. M	Weight (g)	Packaging (pcs.)
<b>IG 1</b>	NPT 3/8"	ANSI B1.20.3				PVM1.1010.013	138	100
<b>AG 7</b>	NPT 3/8"	ANSI B1.20.3	PVM3.1010.022	165	70			

THREADS

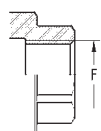
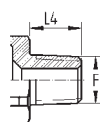
**IG 1**

**AG 7**

**PLASTIC**



NOMINAL SIZE			FEMALE DUST PLUG			MALE DUST CAP			COLOUR	MATERIAL
DNP	BG	ISO	COD. F	Weight (g)	Packaging (pcs.)	COD. M	Weight (g)	Packaging (pcs.)		
10	2	10	SPVS.10001	16	50	SPVS.10001	16	50	RED	Polyethylene
10	2	10	SPVS.10041	16	50	SPVS.10041	16	50	BLACK	Polyethylene

**METAL**



NOMINAL SIZE			FEMALE DUST PLUG			MALE DUST CAP			MATERIAL
DNP	BG	ISO	COD. F	Weight (g)	Packaging (pcs.)	COD. M	Weight (g)	Packaging (pcs.)	
06	1	6.3	SPVS.06100	80	150	SPVS.06101	85	100	Steel with chain
06	1	6.3	SPVS.06102	36	150	SPVS.06103	34	100	Aluminium with chain
10	2	10	SPVS.10100 C	119	100	SPVS.10103 C	109	50	Steel with chain
10	2	10	SPVS.10102 C	49	100				Aluminium with chain
10	2	10	SPVS.10100 L	114	50	SPVS.10103 L	104	50	Steel with plastic tongue
10	2	10	SPVS.10102 L	44	50				Aluminium with plastic tongue

**GUARNIZIONI DI RICAMBIO / SPARE PARTS / ERSATZDICHTUNGEN / JOINTS**

AL CODICE DELLA GUARNIZIONE IN NBR AGGIUNGERE 'E' PER EPDM o 'V' PER VITON

TO THE NBR GASKET CODE ADD 'E' FOR EPDM OR 'V' FOR VITON

ZU DER ARTIKELNR. DER NBR DICHTUNG GEBEN SIE 'E' FUER EPDM ODER 'V' FUER VITON AN

AU CODE DU JOINT EN NBR JOINDRE 'E' POUR EPDM OU 'V' POUR VITON

NOMINAL SIZE			FEMALE GASKET	
DNP	BG	ISO	NBR	PTFE
06	1	6.3	PVS.006.120	PVS.006.130
10	2	10	PDV.010.120	PVS.010.130