

# PDS1

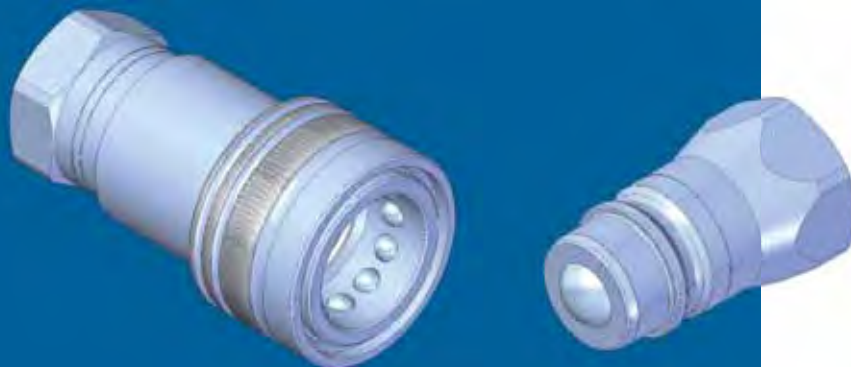

| Nominal size |    |      |      | Max working pressure | Rated flow | Max flow rate | Min burst pressure |        |         | Fluid spillage |
|--------------|----|------|------|----------------------|------------|---------------|--------------------|--------|---------|----------------|
|              |    |      |      |                      |            |               | Male               | Female | Coupled |                |
| DNP          | BG | ISO  | mm   | Mpa                  | l/min      | l/min         | MPa                | MPa    | MPa     | cc             |
| 06           | 1  | 6.3  | 5,3  | 30                   | 12         | 20            | 120                | 120    | 150     | 0,5            |
| 10           | 2  | 10   | 7,4  | 25                   | 23         | 35            | 100                | 100    | 160     | 1,4            |
| 13           | 3  | 12.5 | 8,9  | 20                   | 30         | 55            | 80                 | 95     | 130     | 1,9            |
| 20           | 4  | 19   | 12,4 | 20                   | 60         | 120           | 80                 | 110    | 120     | 4,6            |
| 25           | 5  | 25   | 13,1 | 20                   | 80         | 160           | 85                 | 110    | 100     | 5,9            |

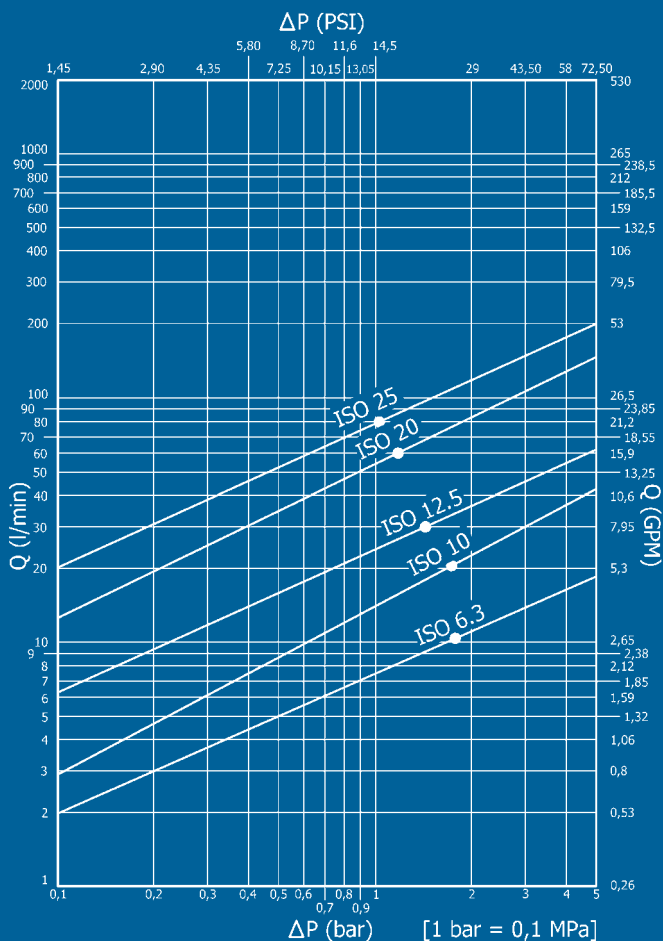

## Caratteristiche tecniche

- Intercambiabilità: con i principali produttori
- Occlusione: sfera
- Aggancio: sfere radiali
- Materiale: acciaio
- Finitura: Zn-Fe (Cr III)
- Filettature: BSP – NPT
- Guarnizioni standard: NBR
- Temperatura d'esercizio: -25 °C +100 °C
- Guarnizioni opzionali: FKM, EPDM o altro
- Pressioni di esercizio: 200-300 bar
- Connessione in pressione: non consentita

## Technical data

- Interchange: with the main producers
- Occlusion: ball
- Locking: radial balls
- Material: steel
- Finishing: Zn-Fe (Cr III)
- Threads: BSP – NPT
- Standard seals: NBR
- Working temperature: -25 °C +100 °C
- Optional seals: FKM, EPDM or more
- Working pressure: 200-300 bar
- Connection under pressure: not allowed

## Technische Merkmale

- Austauschbarkeit: mit den wichtigsten Lieferanten
- Verschluss: kugel
- Kupplung: Radialkugeln
- Werkstoff: Stahl
- Ausführung: Zn-Fe (Cr III)
- Gewinde: BSP – NPT
- Standard-Dichtungen: NBR
- Betriebstemperatur: -25 °C +100 °C
- Dichtungen nach Wahl: FKM, EPDM, usw.
- Betriebsdruck: 200-300 bar
- Kuppeln unter Druck: nicht möglich

## Caracteristiques techniques

- Intercambiabilité: avec les principaux producteurs
- Obturation: bille
- Accrochage: billes radiales
- Matériel: acier
- Traitement: Zn-Fe (Cr III)
- Taraudage: BSP – NPT
- Joints standard: NBR
- Température de service: -25 °C +100 °C
- Joints facultatifs: FKM, EPDM, ect.
- Pression de service: 200-300 bar
- Connexion sous pression: pas possible

### PDS1 DN06 - BG 1 - ISO 6.3

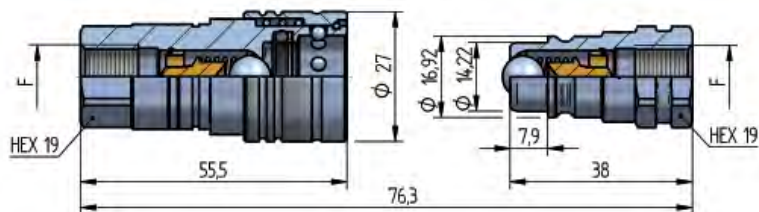

| F        | STANDARD     | FEMMINA - FEMALE - MUFFE - FEMELLE |            |                  | MASCHIO - MALE - STECKER - MALE |            |                  |
|----------|--------------|------------------------------------|------------|------------------|---------------------------------|------------|------------------|
|          |              | COD. F                             | Weight (g) | Packaging (pcs.) | COD. M                          | Weight (g) | Packaging (pcs.) |
| BSP 1/4" | DIN 3852-2-X | PDS1.0606.002                      | 127        | 100              | PDS1.0606.003                   | 47         | 300              |
| NPT 1/4" | ANSI B1.20.3 | PDS1.0606.012                      | 128        | 100              | PDS1.0606.013                   | 48         | 300              |

### PDS1 DN10 - BG 2 - ISO 10

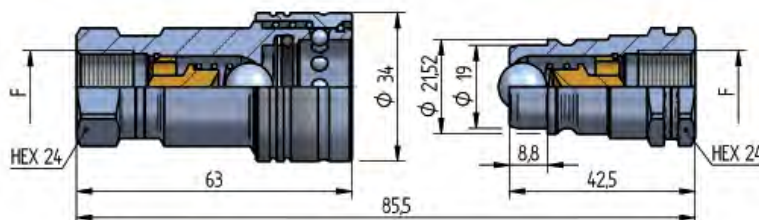

| F        | STANDARD     | FEMMINA - FEMALE - MUFFE - FEMELLE |            |                  | MASCHIO - MALE - STECKER - MALE |            |                  |
|----------|--------------|------------------------------------|------------|------------------|---------------------------------|------------|------------------|
|          |              | COD. F                             | Weight (g) | Packaging (pcs.) | COD. M                          | Weight (g) | Packaging (pcs.) |
| BSP 3/8" | DIN 3852-2-X | PDS1.1010.002                      | 207        | 56               | PDS1.1010.003                   | 86         | 200              |
| NPT 3/8" | ANSI B1.20.3 | PDS1.1010.012                      | 208        | 56               | PDS1.1010.013                   | 87         | 200              |

### PDS1 DN13 - BG 3 - ISO 12.5

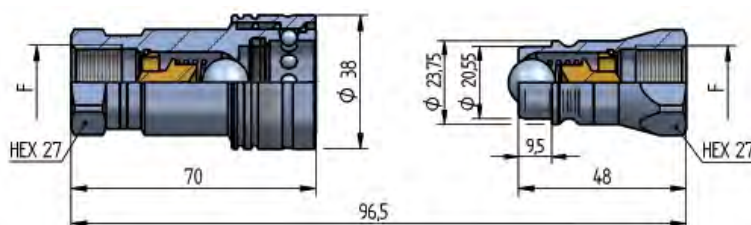

| THREADS | F              | STANDARD     | FEMMINA - FEMALE - MUFFE - FEMELLE |            |                  | MASCHIO - MALE - STECKER - MALE |            |                  |
|---------|----------------|--------------|------------------------------------|------------|------------------|---------------------------------|------------|------------------|
|         |                |              | COD. F                             | Weight (g) | Packaging (pcs.) | COD. M                          | Weight (g) | Packaging (pcs.) |
| IG1     | BSP 1/2"       | DIN 3852-2-X | PDS1.1313.002                      | 273        | 50               | PDS1.1313.003                   | 101        | 200              |
|         | NPT 1/2"       | ANSI B1.20.3 | PDS1.1313.012                      | 275        | 50               | PDS1.1313.013                   | 103        | 200              |
| IG2     | 3/4"-16 UNF 2B | SAE J 1926-1 | PDS1.1319.032                      | 281        | 50               | PDS4.1319.033                   | 108        | 200              |

THREADS

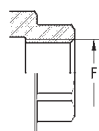

IG 1

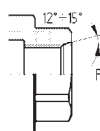

IG 2

### PDS1 DN20 - BG 4 - ISO 19

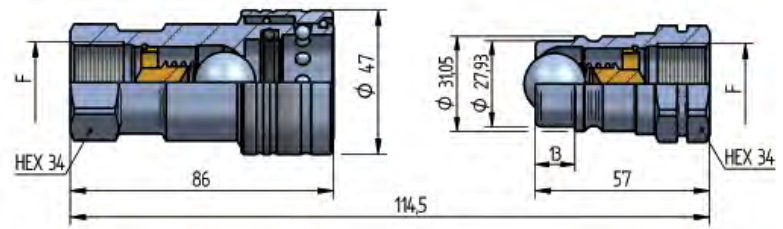

| F        | STANDARD     | FEMMINA - FEMALE - MUFFE - FEMELLE |            |                  | MASCHIO - MALE - STECKER - MALE |            |                  |
|----------|--------------|------------------------------------|------------|------------------|---------------------------------|------------|------------------|
|          |              | COD. F                             | Weight (g) | Packaging (pcs.) | COD. M                          | Weight (g) | Packaging (pcs.) |
| BSP 3/4" | DIN 3852-2-X | PDS1.2019.002                      | 494        | 28               | PDS1.2019.003                   | 205        | 45               |
| NPT 3/4" | ANSI B1.20.3 | PDS1.2019.012                      | 500        | 28               | PDS1.2019.013                   | 210        | 45               |

### PDS1 DN25 - BG 5 - ISO 25

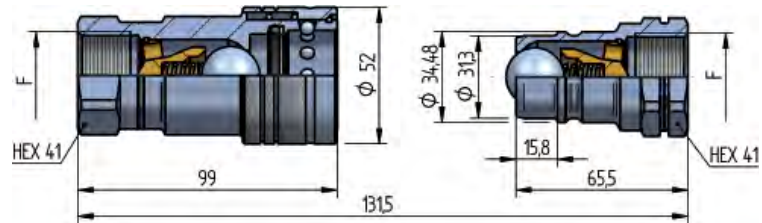

| F      | STANDARD     | FEMMINA - FEMALE - MUFFE - FEMELLE |            |                  | MASCHIO - MALE - STECKER - MALE |            |                  |
|--------|--------------|------------------------------------|------------|------------------|---------------------------------|------------|------------------|
|        |              | COD. F                             | Weight (g) | Packaging (pcs.) | COD. M                          | Weight (g) | Packaging (pcs.) |
| BSP 1" | DIN 3852-2-X | PDS1.2525.002                      | 768        | 20               | PDS1.2525.003                   | 302        | 30               |
| NPT 1" | ANSI B1.20.3 | PDS1.2525.012                      | 775        | 20               | PDS1.2525.013                   | 310        | 30               |

**PLASTIC**

| NOMINAL SIZE |    |      | FEMALE DUST PLUG |            |                  | MALE DUST CAP |            |                  | COLOUR | MATERIAL |
|--------------|----|------|------------------|------------|------------------|---------------|------------|------------------|--------|----------|
| DNP          | BG | ISO  | COD. F           | Weight (g) | Packaging (pcs.) | COD. M        | Weight (g) | Packaging (pcs.) |        |          |
| 06           | 1  | 6.3  | SPDV.06002       | 13         | 150              | SPDV.06003    | 15         | 150              | RED    | PVC      |
| 10           | 2  | 10   | SPDV.10002       | 15         | 100              | SPDV.10003    | 18         | 100              | RED    | PVC      |
| 10           | 2  | 10   | SPDV.10032       | 15         | 100              | SPDV.10033    | 18         | 100              | BLUE   | PVC      |
| 13           | 3  | 12.5 | SPAV.13002       | 20         | 50               | SPAV.13003    | 21         | 50               | RED    | PVC      |
| 13           | 3  | 12.5 | SPAV.13012       | 20         | 50               | SPAV.13013    | 21         | 50               | YELLOW | PVC      |
| 13           | 3  | 12.5 | SPAV.13022       | 20         | 50               | SPAV.13023    | 21         | 50               | GREEN  | PVC      |
| 13           | 3  | 12.5 | SPAV.13032       | 20         | 50               | SPAV.13033    | 21         | 50               | BLUE   | PVC      |
| 13           | 3  | 12.5 | SPAV.13042       | 20         | 50               | SPAV.13043    | 21         | 50               | BLACK  | PVC      |
| 13           | 3  | 12.5 | SPAV.13052       | 20         | 50               | SPAV.13053    | 21         | 50               | WHITE  | PVC      |
| 20           | 4  | 19   | SPDV.20002       | 34         | 25               | SPDV.20003    | 40         | 40               | RED    | PVC      |
| 25           | 5  | 25   | SPDV.25002       | 41         | 30               | SPDV.25003    | 50         | 30               | RED    | PVC      |

**METAL**

| NOMINAL SIZE |    |      | FEMALE DUST PLUG |            |                  | MALE DUST CAP |            |                  | COLOUR | MATERIAL  |
|--------------|----|------|------------------|------------|------------------|---------------|------------|------------------|--------|-----------|
| DNP          | BG | ISO  | COD. F           | Weight (g) | Packaging (pcs.) | COD. M        | Weight (g) | Packaging (pcs.) |        |           |
| 13           | 3  | 12.5 | SPAV.13202       | 51         | 50               | SPAV.13203    | 70         | 50               | -      | Aluminium |

**GUARNIZIONI DI RICAMBIO / SPARE PARTS / ERSATZDICHTUNGEN / JOINTS**

AL CODICE DELLA GUARNIZIONE IN NBR AGGIUNGERE 'E' PER EPDM o 'V' PER VITON

TO THE NBR GASKET CODE ADD 'E' FOR EPDM OR 'V' FOR VITON

ZU DER ARTIKELNR. DER NBR DICHTUNG GEBEN SIE 'E' FUER EPDM ODER 'V' FUER VITON AN

AU CODE DU JOINT EN NBR JOINDRE 'E' POUR EPDM OU 'V' POUR VITON

| NOMINAL SIZE |    |      | FEMALE GASKET |             |
|--------------|----|------|---------------|-------------|
| DNP          | BG | ISO  | NBR           | PTFE        |
| 06           | 1  | 6.3  | PDV.006.120   | PDV.006.130 |
| 10           | 2  | 10   | PDV.010.120   | PDV.010.130 |
| 13           | 3  | 12.5 | PAV.013.120   | PAV.013.130 |
| 20           | 4  | 19   | PDV.019.120   | PVV.019.130 |
| 25           | 5  | 25   | PDV.025.120   | PDV.025.130 |