

PAO1-PAOC

Caratteristiche tecniche

- Norma: ISO 7241-1 A
- Occlusione: passaggio libero
- Aggancio: sfere radiali
- Materiale: acciaio
- Finitura: Zn-Fe (PAO1) / cromatura (PAOC)
- Filettature: BSP – NPT – RC
- Guarnizioni standard: NBR (PAO1) / FKM (PAOC)
- Temperatura d'esercizio (PAO1): -25 °C +100 °C
- Temperatura d'esercizio (PAOC): -25 °C +200 °C
- Guarnizioni opzionali: FKM, EPDM o altro
- Pressioni di esercizio: 250-350 bar

Technical data

- Standard: ISO 7241-1 A
- Occlusion: free flow
- Locking: radial balls
- Material: steel
- Finishing: Zn-Fe (PAO1) / chroming (PAOC)
- Threads: BSP – NPT – RC
- Standard seals: NBR (PAO1) / FKM (PAOC)
- Working temperature (PAO1): -25 °C +100 °C
- Working temperature (PAOC): -25 °C +200 °C
- Optional seals: FKM, EPDM or more
- Working pressure: 250-350 bar

Technische Merkmale

- Norm: ISO 7241-1 A
- Verschluss: freier Durchlauf
- Kupplung: Radialkugeln
- Werkstoff: Stahl
- Ausführung: Zn-Fe (PAO1) / Verchromung (PAOC)
- Gewinde: BSP – NPT – RC
- Standard-Dichtungen: NBR (PAO1) / FKM (PAOC)
- Betriebstemperatur (PAO1): -25 °C +100 °C
- Betriebstemperatur (PAOC): -25 °C +200 °C
- Dichtungen nach Wahl: FKM, EPDM, usw.
- Betriebsdruck: 250-350 bar

Caracteristiques techniques

- Norme: ISO 7241-1 A
- Obturation: passage libre
- Accrochage: billes radiales
- Matériel: acier
- Traitement: Zn-Fe (PAO1) / chromage (PAOC)
- Taraudage: BSP – NPT – RC
- Joints standard: NBR (PAO1) / FKM (PAOC)
- Température de service (PAO1): -25 °C +100 °C
- Température de service (PAOC): -25 °C +200 °C
- Joints facultatifs: FKM, EPDM, ect.
- Pression de service: 250-350 bar

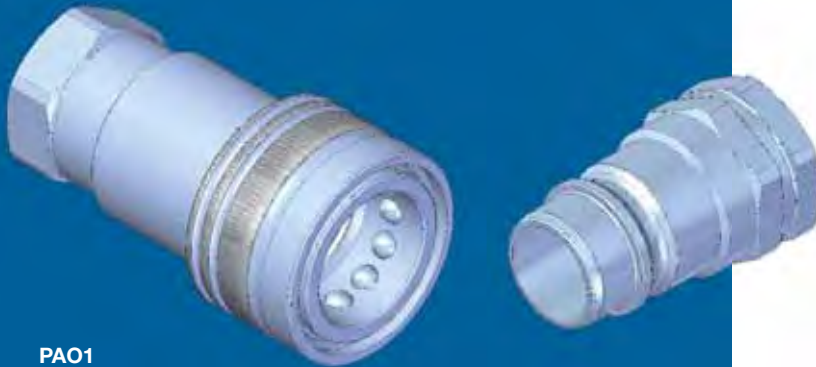

PAO1

Nominal size				Max working pressure	Rated flow	Max flow rate	Min burst pressure			Fluid spillage
							Male	Female	Coupled	
DNP	BG	ISO	mm	Mpa	l/min	l/min	MPa	MPa	MPa	cc
06	1	6.3	5,5	35	12	24	-	-	140	-
10	2	10	9	35	23	46	-	-	150	-
13	3	12.5	11,5	30	45	90	-	-	120	-
20	4	19	16,5	25	106	220	-	-	100	-
25	5	25	19	25	189	380	-	-	100	-
30	6	31.5	24,5	25	288	580	-	-	100	-

PAOC

Nominal size				Max working pressure	Rated flow	Max flow rate	Min burst pressure			Fluid spillage
							Male	Female	Coupled	
DNP	BG	ISO	mm	Mpa	l/min	l/min	MPa	MPa	MPa	cc
10	2	10	13	35	45	90	-	-	150	-
13	3	12.5	17,2	30	189	380	-	-	120	-
20	4	19	23,2	25	288	580	-	-	100	-
25	5	25	28,2	25	379	760	-	-	100	-

PA01 DN06 - BG 1 - ISO 6.3

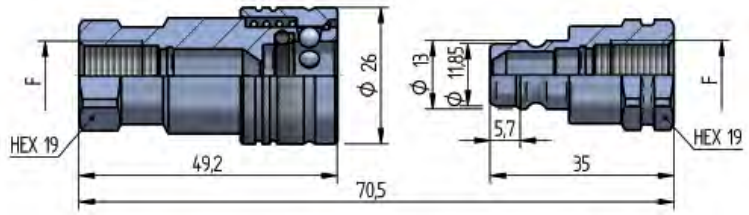

F	STANDARD	FEMMINA - FEMALE - MUFFE - FEMELLE			MASCHIO - MALE - STECKER - MALE		
		COD. F	Weight (g)	Packaging (pcs.)	COD. M	Weight (g)	Packaging (pcs.)
BSP 1/4"	DIN 3852-2-X	PA01.0606.002	102	180	PA01.0606.003	33	300
NPT 1/4"	ANSI B1.20.3	PA01.0606.012	103	180	PA01.0606.013	34	300
RC 1/4"	UNI ISO 7/1	PA01.0606.042	103	180	PA01.0606.043	34	300

PA01 DN10 - BG 2 - ISO 10

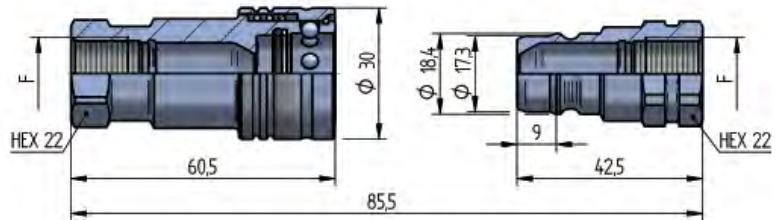

F	STANDARD	FEMMINA - FEMALE - MUFFE - FEMELLE			MASCHIO - MALE - STECKER - MALE		
		COD. F	Weight (g)	Packaging (pcs.)	COD. M	Weight (g)	Packaging (pcs.)
BSP 3/8"	DIN 3852-2-X	PA01.1010.002	146	100	PA01.1010.003	50	200
NPT 3/8"	ANSI B1.20.3	PA01.1010.012	147	100	PA01.1010.013	51	200
RC 3/8"	UNI ISO 7/1	PA01.1010.042	147	100	PA01.1010.043	51	200

PAOC DN10 - BG 2 - ISO 10

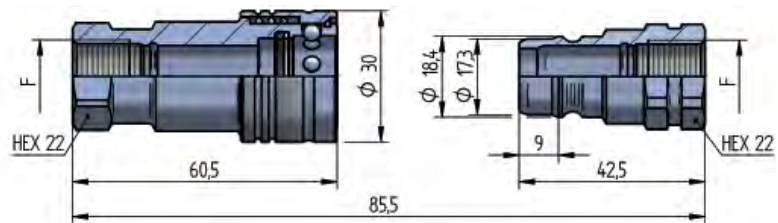

F	STANDARD	FEMMINA - FEMALE - MUFFE - FEMELLE			MASCHIO - MALE - STECKER - MALE		
		COD. F	Weight (g)	Packaging (pcs.)	COD. M	Weight (g)	Packaging (pcs.)
BSP 3/8"	DIN 3852-2-X	PAOC.1010.002	145	100	PAOC.1010.003	49	200

THREADS

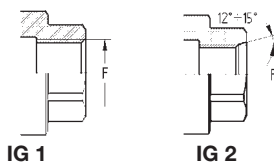

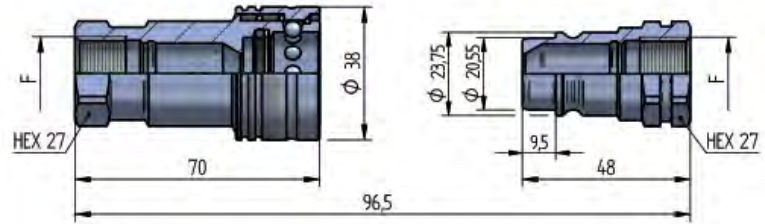
PA01 DN13 - BG 3 - ISO 12.5

THREADS	F	STANDARD	FEMMINA - FEMALE - MUFFE - FEMELLE			MASCHIO - MALE - STECKER - MALE		
			COD. F	Weight (g)	Packaging (pcs.)	COD. M	Weight (g)	Packaging (pcs.)
IG1	BSP 1/2"	DIN 3852-2-X	PA01.1313.002	250	50	PA01.1313.003	80	200
	NPT 1/2"	ANSI B1.20.3	PA01.1313.012	251	50	PA01.1313.013	81	200
	RC 1/2"	UNI ISO 7/1	PA01.1313.042	251	50	PA01.1313.043	81	200
IG2	M22x1,5	SAE J 2244/1	PA01.1322.102	243	50	PA01.1322.103	73	200

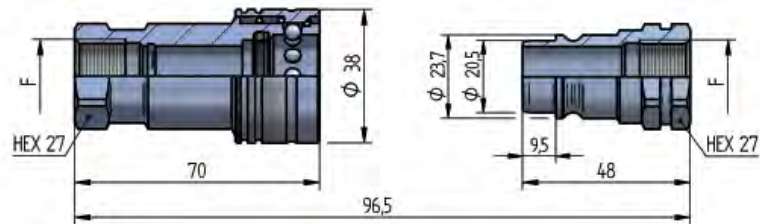
PAOC DN13 - BG 3 - ISO 12.5

F	STANDARD	FEMMINA - FEMALE - MUFFE - FEMELLE			MASCHIO - MALE - STECKER - MALE		
		COD. F	Weight (g)	Packaging (pcs.)	COD. M	Weight (g)	Packaging (pcs.)
BSP 1/2"	DIN 3852-2-X	PAOC.1313.002	246	50	PAOC.1313.003	76	200

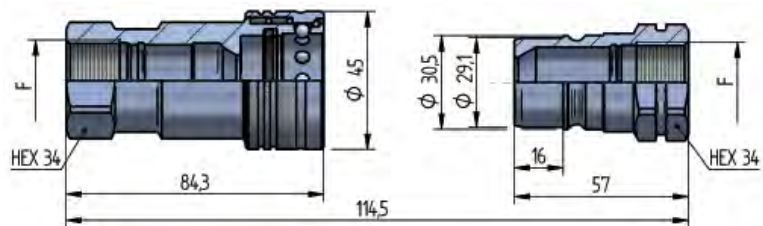
PA01 DN20 - BG 4 - ISO 19

F	STANDARD	FEMMINA - FEMALE - MUFFE - FEMELLE			MASCHIO - MALE - STECKER - MALE		
		COD. F	Weight (g)	Packaging (pcs.)	COD. M	Weight (g)	Packaging (pcs.)
BSP 3/4"	DIN 3852-2-X	PA01.2019.002	398	28	PA01.2019.003	149	45
NPT 3/4"	ANSI B1.20.3	PA01.2019.012	402	28	PA01.2019.013	153	45
RC 3/4"	UNI ISO 7/1	PA01.2019.042	402	28	PA01.2019.043	153	45

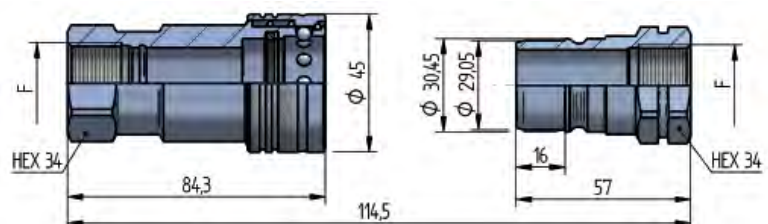
PAOC DN20 - BG 4 - ISO 19

F	STANDARD	FEMMINA - FEMALE - MUFFE - FEMELLE			MASCHIO - MALE - STECKER - MALE		
		COD. F	Weight (g)	Packaging (pcs.)	COD. M	Weight (g)	Packaging (pcs.)
BSP 3/4"	DIN 3852-2-X	PAOC.2019.002	394	28	PAOC.2019.003	145	45

PA01 DN25 - BG 5 - ISO 25

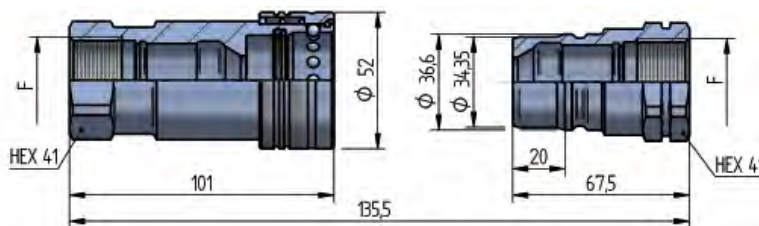

F	STANDARD	FEMMINA - FEMALE - MUFFE - FEMELLE			MASCHIO - MALE - STECKER - MALE		
		COD. F	Weight (g)	Packaging (pcs.)	COD. M	Weight (g)	Packaging (pcs.)
BSP 1"	DIN 3852-2-X	PA01.2525.002	629	20	PA01.2525.003	243	30
NPT 1"	ANSI B1.20.3	PA01.2525.012	638	20	PA01.2525.013	252	30
RC 1"	UNI ISO 7/1	PA01.2525.042	638	20	PA01.2525.043	252	30

PAOC DN25 - BG 5 - ISO 25

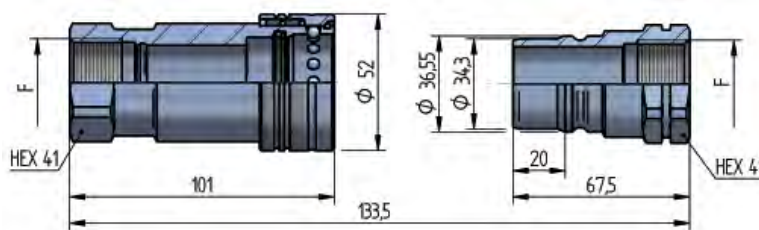

F	STANDARD	FEMMINA - FEMALE - MUFFE - FEMELLE			MASCHIO - MALE - STECKER - MALE		
		COD. F	Weight (g)	Packaging (pcs.)	COD. M	Weight (g)	Packaging (pcs.)
BSP 1"	DIN 3852-2-X	PAOC.2525.002	620	20	PAOC.2525.003	234	30

PA01 DN30 - BG 6 - ISO 31.5

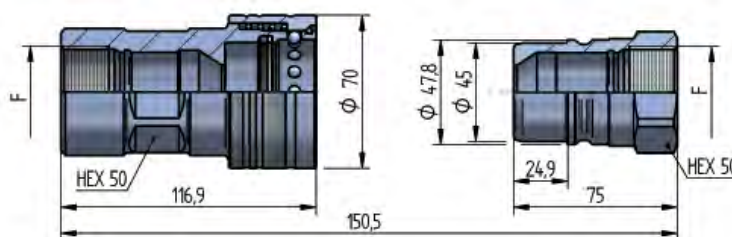

F	STANDARD	FEMMINA - FEMALE - MUFFE - FEMELLE			MASCHIO - MALE - STECKER - MALE		
		COD. F	Weight (g)	Packaging (pcs.)	COD. M	Weight (g)	Packaging (pcs.)
BSP 1"¼	DIN 3852-2-X	PA01.3031.002	1381	12	PA01.3031.003	425	20
NPT 1"¼	ANSI B1.20.3	PA01.3031.012	1392	12	PA01.3031.013	436	20
RC 1"¼	UNI ISO 7/1	PA01.3031.042	1392	12	PA01.3031.043	436	20

PLASTIC

NOMINAL SIZE		FEMALE DUST PLUG				MALE DUST CAP				COLOUR	MATERIAL
DNP	BG	ISO	COD. F	Weight (g)	Packaging (pcs.)	COD. M	Weight (g)	Packaging (pcs.)			
06	1	6.3	SPAV.06002	4	200	SPAV.06003	4	150	RED	Polyethylene	
10	2	10	SPAV.10002	14	100	SPAV.10003	16	100	RED	PVC	
13	3	12.5	SPAV.13002	20	50	SPAV.13003	21	50	RED	PVC	
13	3	12.5	SPAV.13012	20	50	SPAV.13013	21	50	YELLOW	PVC	
13	3	12.5	SPAV.13022	20	50	SPAV.13023	21	50	GREEN	PVC	
13	3	12.5	SPAV.13032	20	50	SPAV.13033	21	50	BLUE	PVC	
13	3	12.5	SPAV.13042	20	50	SPAV.13043	21	50	BLACK	PVC	
13	3	12.5	SPAV.13052	20	50	SPAV.13053	21	50	WHITE	PVC	
20	4	19	SPAV.20002	33	50	SPAV.20003	39	25	RED	PVC	
25	5	25	SPAV.25002	16	50	SPAV.25003	19	25	RED	Polyethylene	

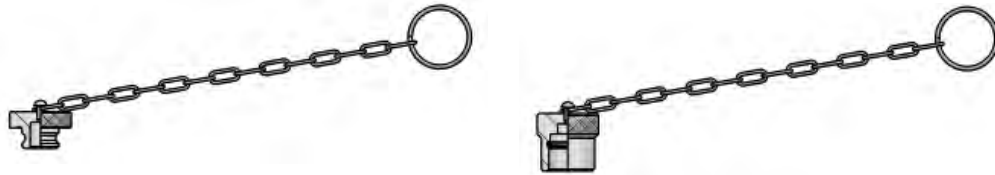
METAL

NOMINAL SIZE		FEMALE DUST PLUG				MALE DUST CAP				COLOUR	MATERIAL
DNP	BG	ISO	COD. F	Weight (g)	Packaging (pcs.)	COD. M	Weight (g)	Packaging (pcs.)			
06	1	6.3	SPAV.06202*	33	100	SPAV.06203*	35	100	-	Aluminium	
10	2	10	SPAV.10202	42	80	SPAV.10203	50	80	-	Aluminium	
13	3	12.5	SPAV.13202	51	50	SPAV.13203	70	50	-	Aluminium	
20	4	19	SPAV.20202	66	25	SPAV.20203	107	25	-	Aluminium	
25	5	25	SPAV.25202*	88	20	SPAV.25203*	160	20	-	Aluminium	
30	6	31.5	SPAV.30202	119	15	SPAV.30203	280	15	-	Aluminium	

* REALIZZATI SU RICHIESTA DEL CLIENTE - AVAILABLE ON REQUEST - AUF ANFRAGE LIEFERBAR - DISPONIBLES SUR DEMANDE

GUARNIZIONI DI RICAMBIO / SPARE PARTS / ERSATZDICHTUNGEN / JOINTS

AL CODICE DELLA GUARNIZIONE IN NBR AGGIUNGERE 'E' PER EPDM o 'V' PER VITON

TO THE NBR GASKET CODE ADD 'E' FOR EPDM OR 'V' FOR VITON

ZU DER ARTIKELNR. DER NBR DICHTUNG GEBEN SIE 'E' FUER EPDM ODER 'V' FUER VITON AN

AU CODE DU JOINT EN NBR JOINDRE 'E' POUR EPDM OU 'V' POUR VITON

NOMINAL SIZE			FEMALE GASKET	
DNP	BG	ISO	NBR	PTFE
06	1	6.3	PAV.006.120	PAV.006.130
10	2	10	PAV.010.120	PAV.010.130
13	3	12.5	PAV.013.120	PAV.013.130
20	4	19	PAV.019.120	PAV.019.130
25	5	25	PAV.025.120	PAV.025.130
30	6	31.5	PAV.030.120	PAV.030.130